

MODEL	GWC AM28 EB 1.8Nm
Voltage	7.4v RechargeableLithium Battery
Current	1.1A
Power	11 Watt
Speed	25RPM
Limit Setting	Electronic (max 6 limits)
Radio Frequency	433.92MHz
Operating Distance	30 metres
Length	577.5mm
Soft Start/Stop	Yes
Solar Compatible	Yes #802393012
UFO Hub Compatible	Yes
Compatible Tube Sizes	45mm
MinimumBlindSize	648mm
Dimensions	
A B C	577mm
	7mm
	28mm

MODEL	GWC AM28 EB 1.0Nm
Voltage	7.4vRechargeableLithium Battery
Current	900mA
Power	6.7W
Speed	30Rpm
Limit Setting	Electronic (Max 6 Limits)
Radio Frequency	433.92MHz
Operating Distance	30 metres
Length	452mm
Soft Start/Stop	Yes
Solar Compatible	Yes #802393012
UFO Hub Compatible	Yes
Compatible Tube Sizes	45mm
MinimumBlindSize	521mm
Dimensions	
A B C D	451mm
	18mm
	7mm
	25mm

GWC – AM28 Motor

Motor Head

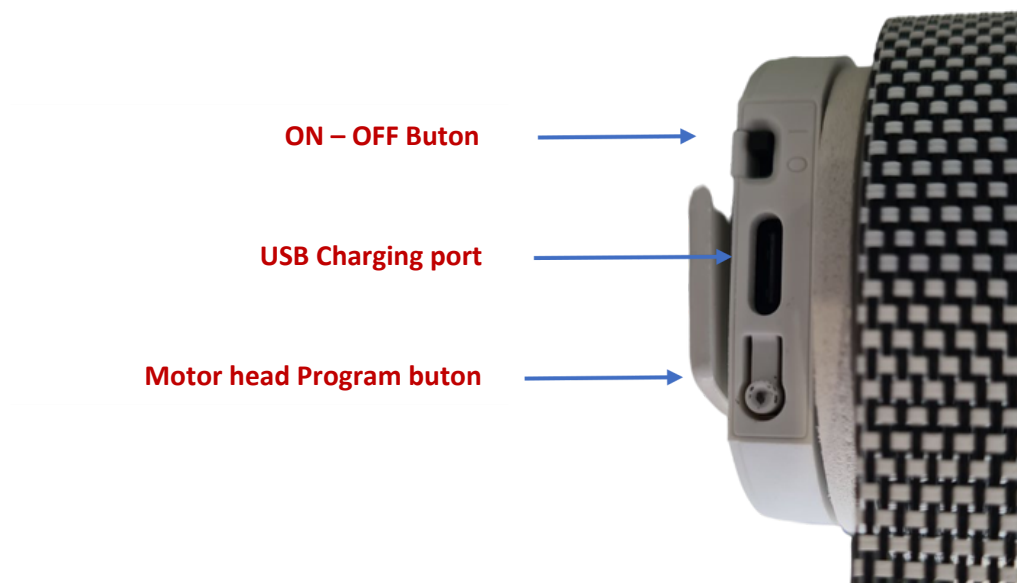

16 Channel Remote

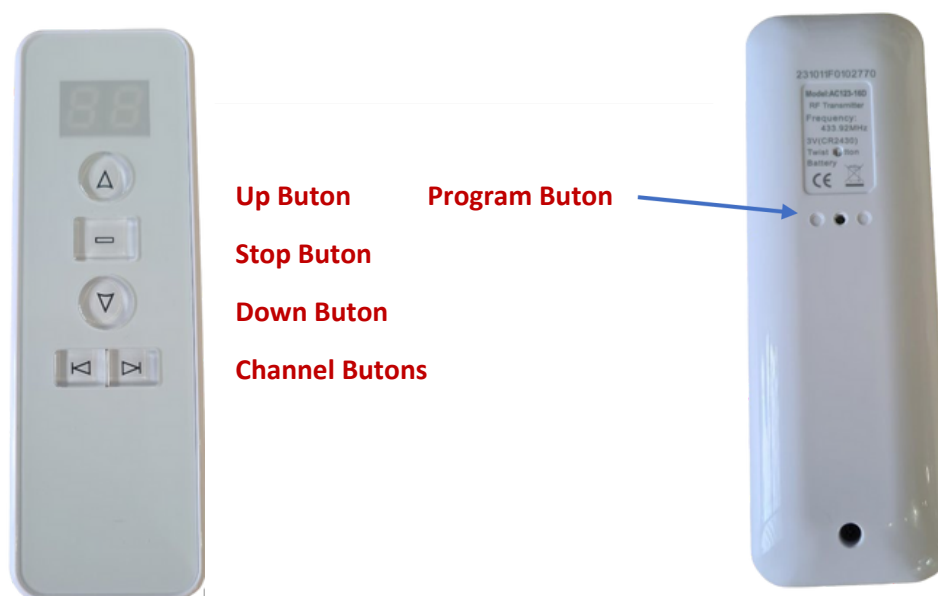

Pairing the Motor to the Remote

On the Remote Select the channel you want to pair the motor to



Push and Hold the programming Buton on the Head of the motor
for approx 1 second, motor will jiggle



Push the Up Buton on the remote



Motor will jiggle



Motor is paired to the channel selected

Motor Direction Change

Push and hold the Stop Button until motor jiggles



Push the down button





Test blind with up and down buttons for correct direction

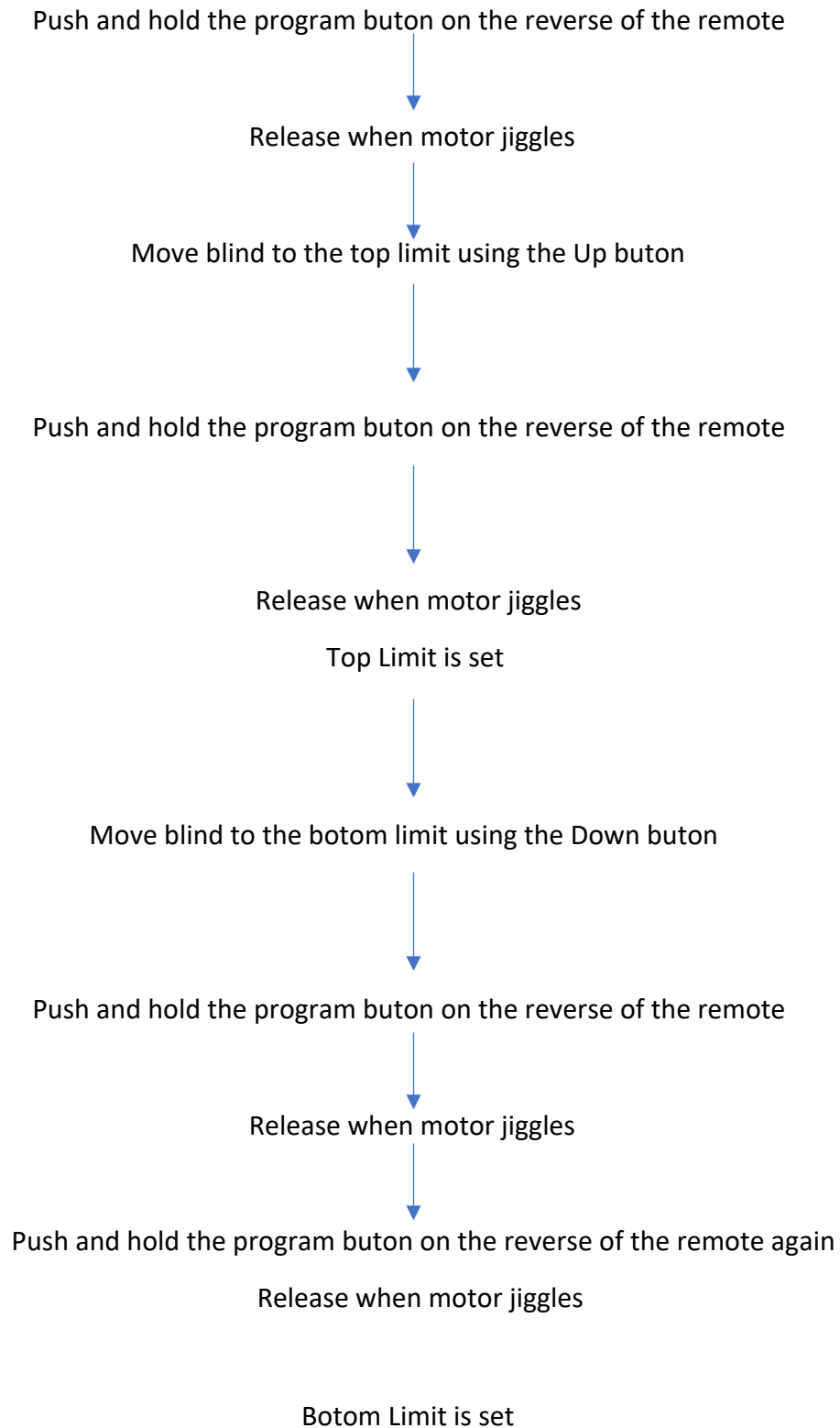

Motor direction has been changed

Limit Setting
(set top limit first)



If a er finishing programming the blind responds with Incremental movements rather than a continuous movement: Press and Hold the Stop Button until the blind jiggles and then press the Stop Button once more, the blind will jiggle, and continuous movement should be restored.

Pairing a Blind to a new Channel

On the remote go to the channel the blind is currently on



Push and hold the stop button until the motor jiggles



Go to the new channel you want to put the blind on



Push the Up button once on the new channel



The blind has been added to this channel

Deleting a blind off a remote

Go to the remote/channel you want to delete the blind off



Wake up the motor by Pressing and Holding the Stop Buton for more than 3 seconds



The motor will jiggle



Within 10 seconds, on the back of the remote push the program buton for 3 seconds



The motor will jiggle and the blind has been removed off the remote it was on

Pairing a Blind to a new Remote

On the current remote go to the channel the blind is currently on



Push and hold the stop button until the motor jiggles



Go to the new remote and pick the channel you want the blind on



Push the Up button once on the new remote



The blind has been added to the new remote on the channel you have picked

Hiding/Unhiding Channels on a remote

On the remote go to the channel you want to hide or make visible

Briefly press the program on the back of the remote (do not hold the program button in)



The channel light on the front of the remote will be flashing



If flashing Fast = Channel Hidden

If flashing Slow = Channel visible



While the channel is flashing press the stop button



This will change the rate of flashing and will change whether the channel is visible or hidden



Press the Program button the rear of the remote briefly exit and save

Extra Programming instructions

1. Intermediate Limits:

Other than the Top and Bottom Limits this motor can store an additional four Intermediate Limits. To set Intermediate Limits: After setting the top and bottom limits and exiting the program mode, move the blind to where you would like an intermediate limit set.

Press the button in the setting hole on the remote control until you get a jiggle now press the button in the setting hole on the remote a second time, you will get a jiggle. An intermediate limit has now been set.

When operating the blind if you do not want to stop at the intermediate limit: Press the button for the direction that you would like the blind to move in; once the blind starts moving press the same button a second time and it will skip that limit and continue onto the furthest limit.

2. Adjusting a Limit after it has been set:

Move the blind to the limit that you wish to adjust, press the button in the setting hole on the remote until you get a jiggle, now move the blind to the new limit position and press the button in the setting hole on the remote; the blind will jiggle, and the limit has been adjusted.

3. To delete an Intermediate Limit or Bottom Limit (Top limit cannot be deleted in this

manner): Move the blind to the limit that you wish to adjust, press the button in the setting hole on the remote until you get a jiggle, now move the blind to the new limit position and press the button in the setting hole on the remote; the blind will jiggle, and the limit has been adjusted.

4. Switch from Automatic Movement to Manual Movement (or Vice Versa)

Wake the motor up by pressing the STOP (middle) button for 5 seconds. The motor will jog. Within 10 seconds, press the STOP button briefly. The motor will jog.

Resetting the Motor

On the remote/channel motor is set on press and hold the stop button



Motor will jiggle



Press and hold the program button on the back of the remote

For 7 seconds



While holding down program button Motor should jiggle once and then jiggle twice



Motor is reset to factory mode